

Plastic Modular Belt

Series **uni ITB** Type **Closed**

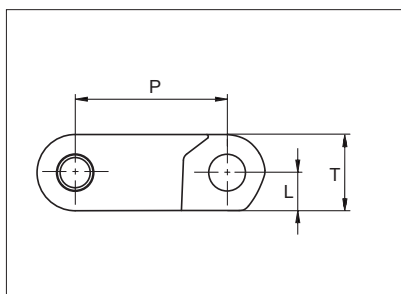
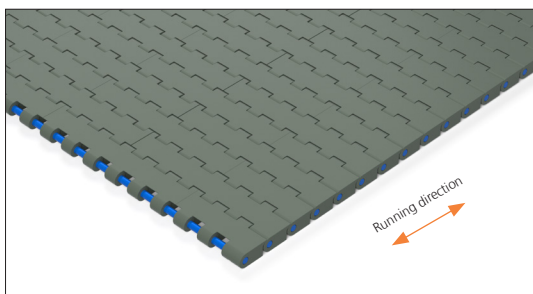

Straight running belt
 Nominal pitch: 25.4 mm (1.00 in)
 Surface type: Flat
 Surface opening: Closed
 Backflex radius: 68 mm (2.68 in)
 Pin diameter: 6.00 mm (0.24 in)

Belt material & color	POM-D G	POM-NL DG	POM-SLF B	mm		in		mm		in	
				P (Nominal)	25.4	1.00	T	12.7	0.50		
Pin material & color	PA6.6 B			L	6.35	0.25					

Non standard material and color: See uni Material and Color Overview. Alternative pin and lock systems and materials: Contact Customer Service.

Belt width		Permissible tensile force (Belt/pin material)		Belt weight (Belt/pin material)		*Min. No. drive sprocket per shaft	Number of wear strips (Min. No.)	
		POM-D-NL-SLF/PA6.6		POM-D-NL-SLF/PA6.6			**Carry (pcs)	**Return (pcs)
mm	in	N	lbf	Kg/m	lb/ft			
153	6.0	6120	1376	2.0	1.37	2	2	2
229	9.0	9160	2059	3.0	2.05	2	2	2
306	12.0	12240	2752	4.1	2.74	3	2	2
382	15.0	15280	3435	5.1	3.41	3	2	2
458	18.0	18320	4118	6.1	4.09	4	2	3
534	21.0	21360	4802	7.1	4.77	4	2	3
610	24.0	24400	5485	8.1	5.45	5	3	3
687	27.0	27480	6178	9.1	6.14	5	3	3
763	30.0	30520	6861	10.1	6.82	6	3	4
839	33.0	33560	7544	11.2	7.50	6	3	4
915	36.0	36600	8228	12.2	8.18	7	3	4
991	39.0	39640	8911	13.2	8.86	7	4	4
1068	42.0	42720	9603	14.2	9.55	8	4	5
1144	45.0	45760	10287	15.2	10.23	8	4	5

General belt tolerance is +0/-0.4% at 23°C/73°F 50% RH. For exact belt width contact Customer Service. Standard belt width increment is 25.4 mm (1.00 in)

*Max. Load per Drive Sprocket. Belt material: POM 3000 N (674 lbf)
 **Max. Spacing between wear strips, Carry: 150 mm (5.9 in) ; Return: 300 mm (11.8 in)

See more belt widths on next page....



STANDARD

STRAIGHT RUNNING

PITCH 25.4 MM/1.00 IN

Belt width		Permissible tensile force (Belt/pin material)		Belt weight (Belt/pin material)		*Min. No. drive sprocket per shaft	Number of wear strips (Min. No.)	
		POM-D-NL-SLF/PA6.6		POM-D-NL-SLF/PA6.6			**Carry (pcs)	**Return (pcs)
mm	in	N	lbf	Kg/m	lb/ft			
1296	51.0	51840	11654	17.2	11.58	9	5	5
1372	54.0	54880	12337	18.2	12.26	10	5	5
1449	57.0	57960	13029	19.3	12.95	10	5	5
1525	60.0	61000	13713	20.3	13.63	11	6	6
1601	63.0	64040	14396	21.3	14.31	11	6	6
1677	66.0	67080	15080	22.3	14.99	12	6	6
1753	69.0	70120	15763	23.3	15.67	12	6	6
1830	72.0	73200	16455	24.4	16.36	13	7	7
1906	75.0	76240	17139	25.3	17.04	13	7	7
1982	78.0	79280	17822	26.4	17.72	14	7	7
2058	81.0	82320	18506	27.4	18.39	14	7	7
2134	84.0	85360	19189	28.4	19.07	15	8	8
2211	87.0	88440	19881	29.4	19.76	15	8	8
2287	90.0	91480	20565	30.4	20.44	16	8	8
2363	93.0	94520	21248	31.4	21.12	16	8	8
2439	96.0	97560	21931	32.4	21.80	17	9	9
2515	99.0	100600	22615	33.4	22.48	17	9	9
2592	102.0	103680	23307	34.5	23.17	18	9	9
2668	105.0	106720	23991	35.5	23.85	18	9	9
2744	108.0	109760	24674	36.5	24.53	19	10	10
2820	111.0	112800	25357	37.5	25.21	19	10	10
2896	114.0	115840	26041	38.5	25.89	20	10	10
2973	117.0	118920	26733	39.5	26.57	20	10	10
3049	120.0	121960	27417	40.6	27.25	21	11	11
3125	123.0	125000	28100	41.6	27.93	21	11	11
3201	126.0	128040	28783	42.6	28.61	22	11	11
3277	129.0	131080	29467	43.6	29.29	22	11	11
3354	132.0	134160	30159	44.6	29.98	23	12	12

General belt tolerance is +0/-0.4% at 23°C/73°F 50% RH. For exact belt width contact Customer Service.
 Standard belt width increment is 25.4 mm (1.00 in)

*Max. Load per Drive Sprocket. Belt material: POM 3000 N (674 lbf)

**Max. Spacing between wear strips, Carry: 150 mm (5.9 in) ; Return: 300 mm (11.8 in)



uni UltraFit Two-Part Sprocket

No. of teeth	Bore size					Overall diameter		Pitch-diameter		Hub-diameter		Dimension A		Dimension B		Sprocket PA6 LG	Adapter POM-D B
	in	1.50	1.57	2.36	2.50												
	mm	38.1	40.0	60.0	63.5	mm	in	mm	in	mm	in	mm	in	mm	in		
Z16		■	■			134.0	5.28	132.7	5.22	106.0	4.17	58.8	2.31	58.8	2.31	✓	✓
Z18		■	■	■	■	150.2	5.91	149.1	5.87	106.0	4.17	67.1	2.64	67.1	2.64	✓	✓
Z21		■	■	■	■	174.6	6.87	173.7	6.84	106.0	4.17	79.6	3.13	79.6	3.13	✓	✓

■ Moulded sprocket with narrow adapter
Width: 25.0 mm (0.98)

■ Moulded sprocket with wider adapter
Width: 75.0 mm (2.95)

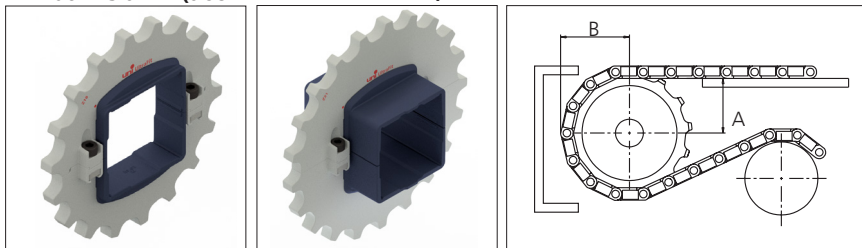

Standard Machined Sprockets

No. of teeth	Bore size					Overall diameter		Pitch-diameter		Hub-diameter		Dimension A		Dimension B		Single row/Two way	Machined PA6 N	
	in	1.18	1.50	1.57	2.36													2.50
	mm	30.0	38.1	40.0	60.0	63.5	mm	in	mm	in	mm	in	mm	in	mm	in		
Z12			■	■			101.7	4.00	99.9	3.93	70.0	2.76	42.0	1.65	56.3	2.21	✓	✓
Z15					■	■	125.9	4.96	124.5	4.90	95.0	3.74	54.6	2.15	68.6	2.70	✓	✓
Z16		●	●				134.0	5.28	132.7	5.22	105.0	4.13	58.8	2.31	72.7	2.86	✓	✓
Z18		●	■	●	■	■	150.2	5.91	149.1	5.87	120.0	4.72	67.1	2.64	80.9	3.18	✓	✓
Z21			■	■	■	■	174.6	6.87	173.7	6.84	140.0	5.51	79.6	3.13	93.2	3.67	✓	✓
Z24					■	■	198.9	7.83	198.4	7.81	160.0	6.30	92.0	3.62	105.5	4.15	✓	✓

● Machined sprocket

■ Machined sprocket

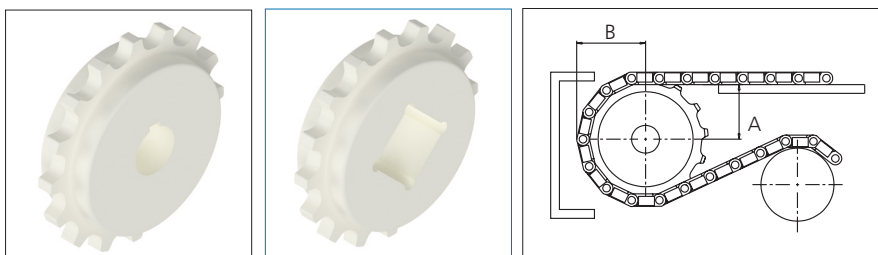

Other sprocket sizes are available upon request.
uni Retainer Rings: See uni Retainer Ring data sheet.
Max load per sprocket shown does not take bore size into account. Please also ensure that sufficient size shaft is chosen for corresponding load.
Width of tooth = 10.0 mm (0.39 in)
Hub width of one-part sprocket = 37.0 mm (1.46 in)

uni ITB: Built to Endure, Engineered for Reliability

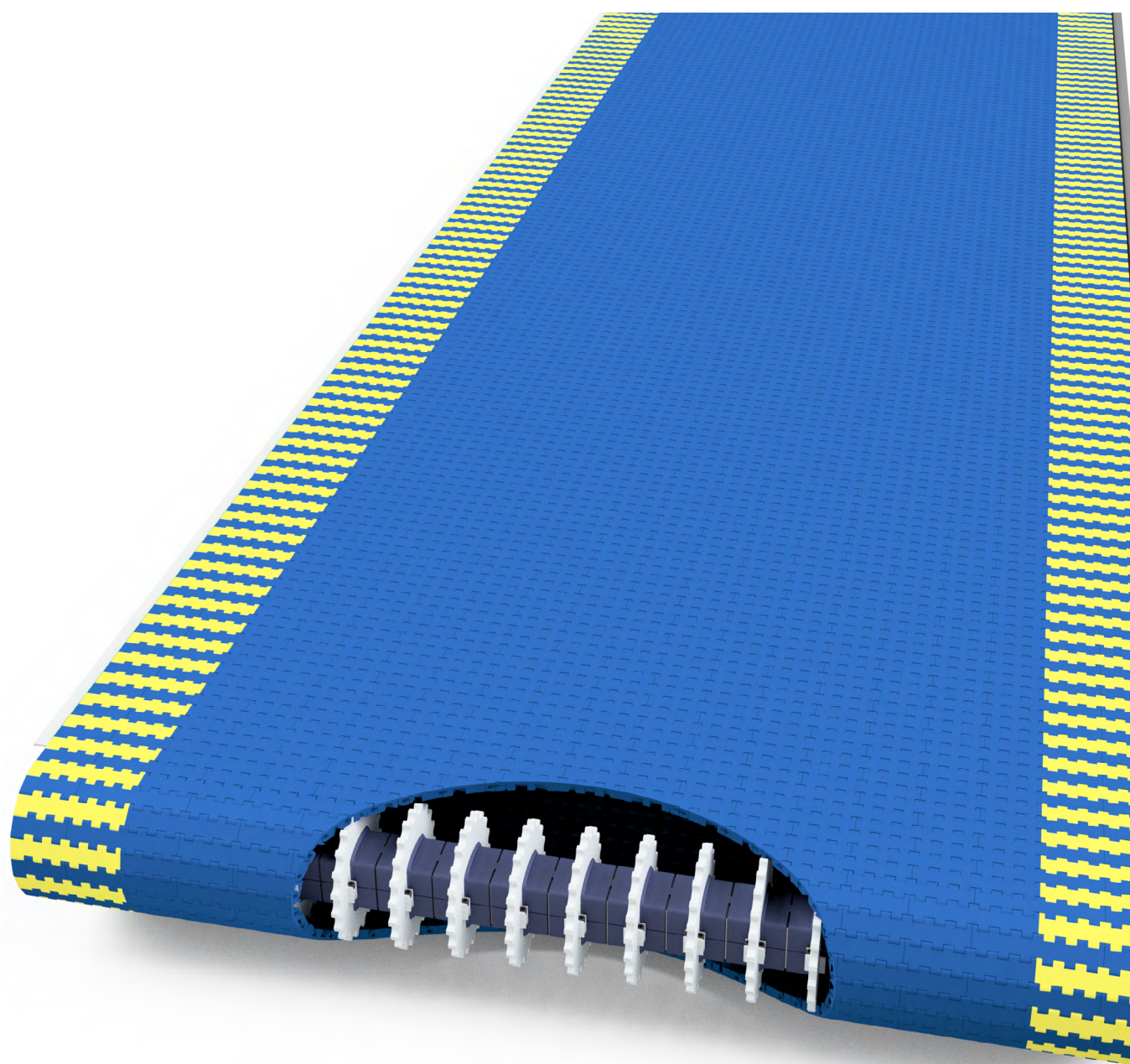

uni ITB - Your Hassle-Free Solution for Demanding Conveyor Tasks

uni-chains, a global leader in manufacturing Modular Belts, introduces a new product:
uni ITB – Industrial Thick Belt

This robust modular belt offers a seamless and high-performing conveyor solutions, addressing key industry challenges. **Ideal for heavy loads, requiring wear and impact resistance, in abrasive environments.** Easy mounting and compatible with modular belts for lateral product transfer. uni ITB caters to companies seeking streamlined operations and increased productivity.

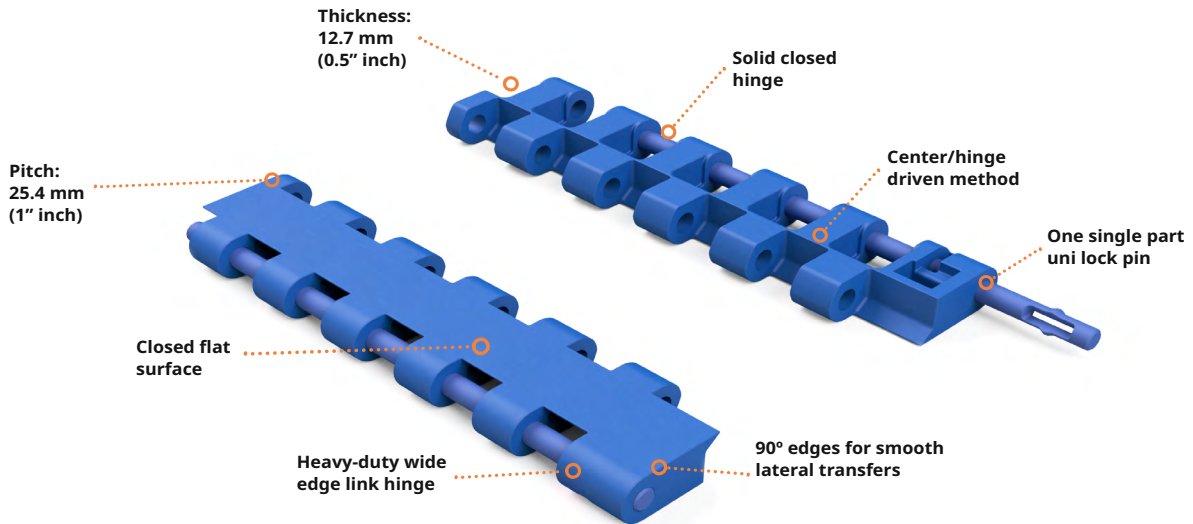

uni ITB width starts from 127.0 mm (5.00 inches), increasing in steps of 25.4 mm (1.00 inch).

uni ITB UltraFit® Sprocket: The Smart Complement

The uni ITB can run on both standard sprockets and UltraFit® Two-part sprockets. The time-saving and cost-cutting feature of the uni UltraFit® lies in its **built-in interchangeable adapters, ensuring perfect alignment of sprockets across the belt width.** These adapters are available in two widths: 25.0 mm (0.98 in) and 76.0 mm (2.99 in).

Additionally, for the uni ITB, the UltraFit® is offered in 16, 18 and 21 teeth, with adapters that fit Metric and Imperial bore sizes, **ensuring compatibility with most existing systems.**

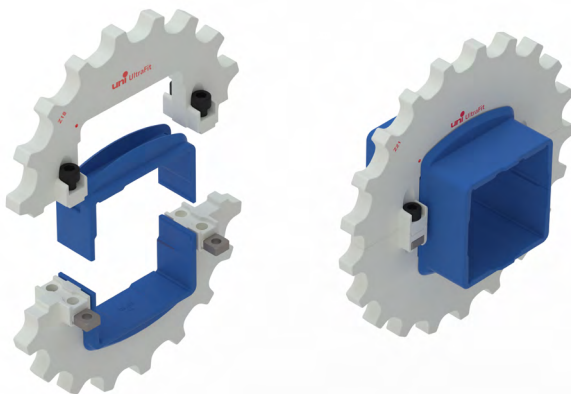
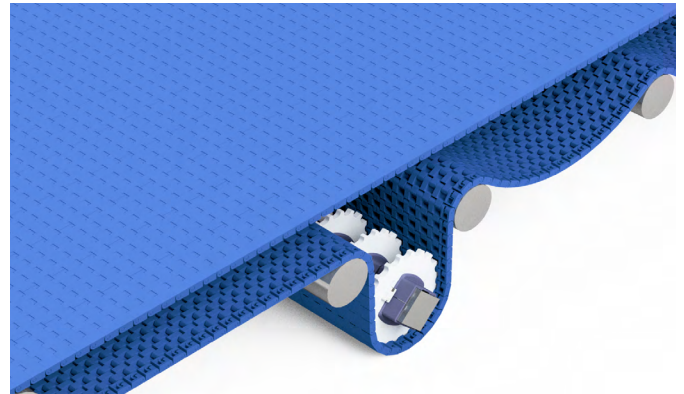

Advantages

- Quick and simple installation/replacement of sprocket
- Easy re-alignment of the belt and improved subsequent performance, thanks to adapters
- Suitable for one-person operation, eliminating heavy lifting
- Ensures outstanding performance and reliability
- Increases efficiency while reducing maintenance costs

uni ITB - The Best Choice For Industrial Applications

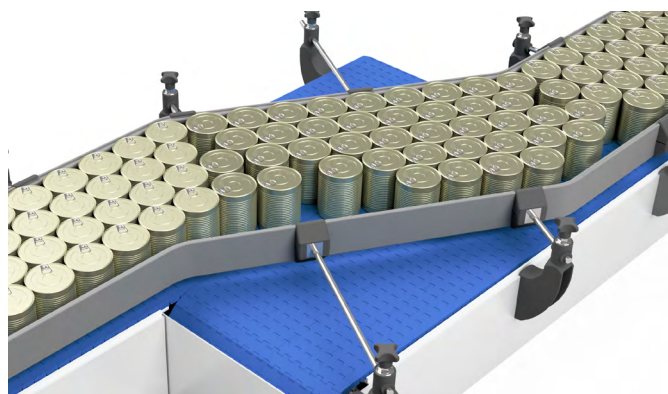
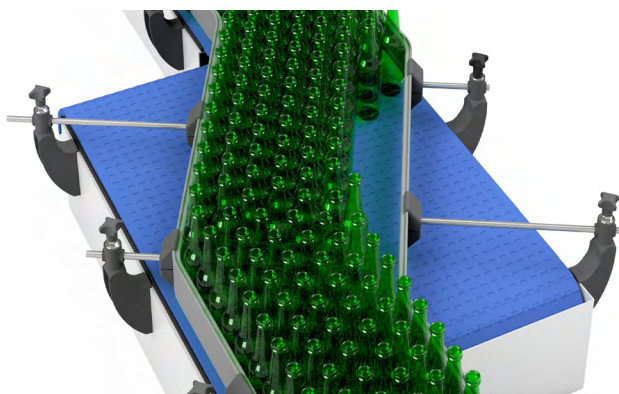
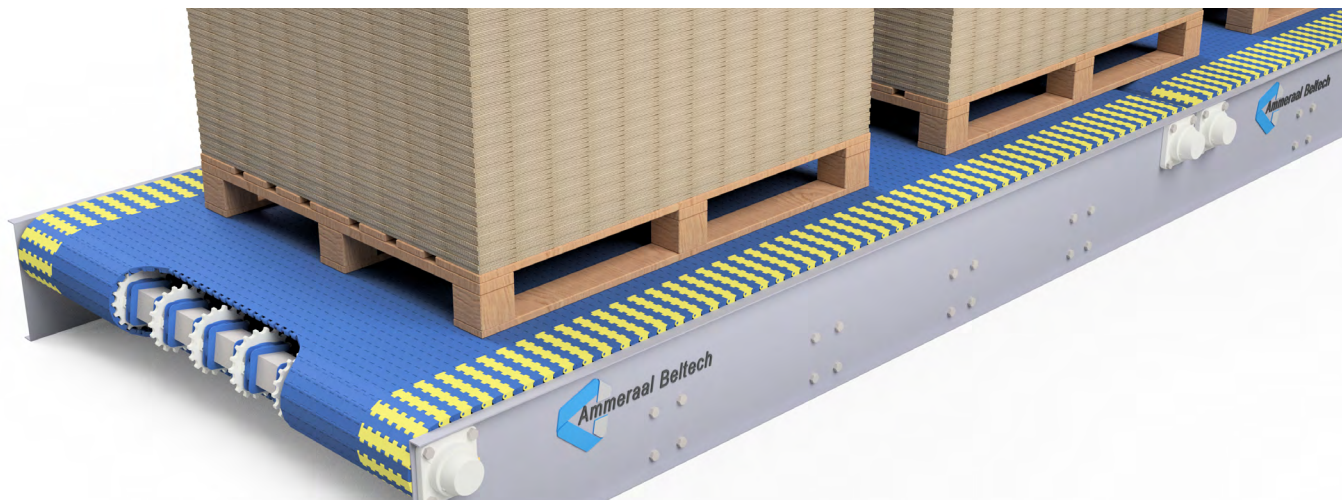

Discover the benefits of uni ITB

Characteristics	Advantages
0.5" Belt Thickness	· The heavy-duty thickness significantly boosts load capacity, ensuring it can withstand the wear of the most demanding manufacturing processes .
1.0" Pitch	· Smaller pitch minimises the polygonal effect , reducing tension fluctuations and enabling smaller inline transfer gaps for precise and consistent product conveying.
Superior Link Flatness	· Top surface flatness enhances product stability .
Solid Closed Hinge	· The solid closed hinge on the underside of the link enhances the belt's wear resistance .
Travel Direction	· The uni ITB can smoothly run in both directions .
uni LockPin System	· uni LockPins offer an ingenious design that guarantees both easy installation and long-term belt security.

Experience **resistant and enduring operations** with our robust **uni ITB belt!**