

# Snap-On Plastic Chain

Series **uni 863** Type **Tab**

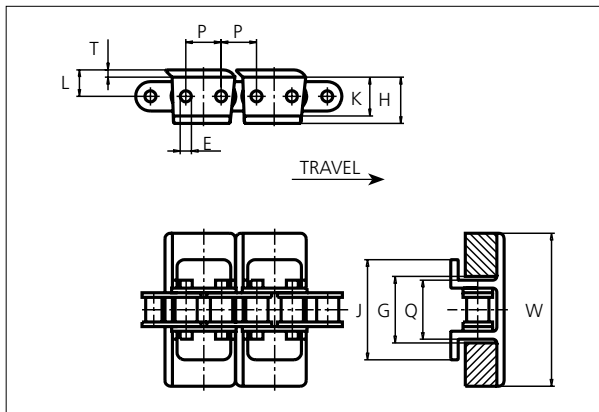

### Snap-On Plastic Chain

Straight running chain  
 Pitch: 19.1 mm (0.75 in)  
 Backflex radius: 150.0 mm (5.90 in)  
 Permissible tensile strength:  
 uni 863 Tab with (SS304) stainless steel chain: 2700 N (600 lbf)  
 uni 863 Tab with carbon steel chain: 5500 N (1200 lbf)

Standard shipping lengths:  
 No. of roller chain links/box:  
 160 = 3.048 m (10.0 ft)  
 No. of flights/box:  
 80 = 3.048 m (10.0 ft)

E		G		H		K		L		P		Q		T	
mm	in	mm	in	mm	in	mm	in	mm	in	mm	in	mm	in	mm	in
6.0	0.24	34.9	1.37	25.1	0.99	20.9	0.82	14.3	0.56	19.1	0.75	31.9	1.25	4.0	0.16

All dimensions are for chains in POM material.

All Snap-On versions can be delivered either with a stainless steel chain (SS304) or a carbon steel chain.

	Width (W)		Flight material & color	Chain material		Weight	
	mm	in				kg/m	lb/ft
<b>K250</b>	63.5	2.50	-	-	-	-	-
<b>K287</b>	73.0	2.87	-	-	-	-	-
<b>K325</b>	82.6	3.25	POM-DI <b>G</b>	<b>SS304</b>	<b>SS430</b>	2.2	1.48
<b>K450</b>	114.3	4.50	-	-	-	-	-
<b>K500</b>	127.0	5.0	-	-	-	-	-
<b>K600</b>	152.4	6.0	-	-	-	-	-
<b>K700</b>	177.8	7.0	-	-	-	-	-
<b>K1000</b>	254.0	10.0	-	-	-	-	-

Non standard material and color: See uni Material and Color Overview.

## Accessories

### Rubber Top

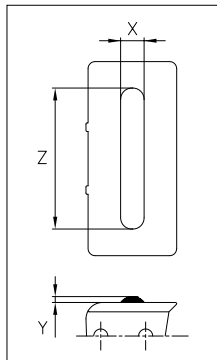

Width	Link material	Rubber material	Z		X		Y	
			mm	in	mm	in	mm	in
<b>K325</b>	POM-DI <b>G</b>	05 <b>I</b>	60.0	2.36	10.0	0.39	2.5	0.10

When ordering, please state the required distance between the Rubber Top.

Other Non Standard rubber profiles: See uni Rubber Profile Overview.



STANDARD

STRAIGHT RUNNING

PITCH 19.1 MM/0.75 IN

# Snap-On Plastic Chain

Series **uni 963** Type **Tab**

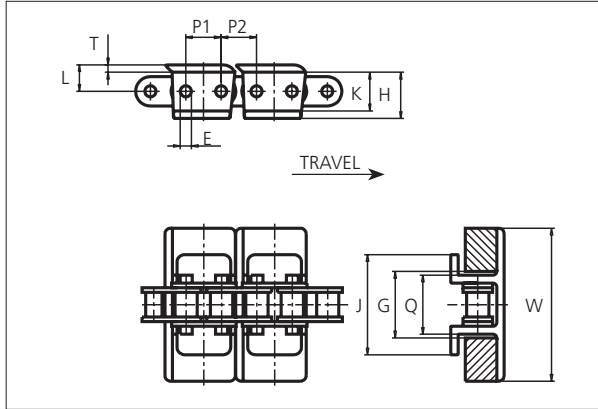

**Snap-On Plastic Chain**  
 Straight running chain  
 Pitch: 19.1 mm (0.75 in)  
 Backflex radius: 150.0 mm (5.90 in)  
 Permissible tensile strength:  
 uni 963 Tab with (SS304) stainless steel chain: 2000 N (450 lbf)  
 uni 963 Tab with carbon steel chain: 4000 N (900 lbf)  
 Standard shipping lengths:  
 No. of roller chain links/box: 160 = 3.048 m (10.0 ft)  
 No. of flights/box: 80 = 3.048 m (10.0 ft)

NON STANDARD

E		G		H		J		K		L		P1		P2		Q		T	
mm	in	mm	in	mm	in	mm	in	mm	in	mm	in	mm	in	mm	in	mm	in	mm	in
5.1	0.20	34.9	1.37	25.1	0.99	50.8	2.00	20.9	0.82	14.3	0.56	18.1	0.71	20.1	0.79	31.9	1.25	4.0	0.16

All dimensions are for chains in POM material.

All Snap-On versions can be delivered either with a stainless steel chain (SS304) or a carbon steel chain.

	Width (W)		Recommended flight material & color	Recommended chain material	Weight	
	mm	in			kg/m	lb/ft
<b>K250</b>	63.5	2.50	POM-DI <b>G</b> POM-LFI <b>BR</b>	SS304 or Carbon steel	2.1	1.41
<b>K325</b>	82.6	3.25	POM-DI <b>G</b> POM-LFI <b>BR</b>	SS304 or Carbon steel	2.2	1.48
<b>K450</b>	114.3	4.50	POM-DI <b>G</b> POM-LFI <b>BR</b>	SS304 or Carbon steel	2.4	1.61
<b>K500</b>	127.0	5.0	POM-DI <b>G</b> POM-LFI <b>BR</b>	SS304 or Carbon steel	2.4	1.61
<b>K1000</b>	254.0	10.0	POM-DI <b>G</b> POM-LFI <b>BR</b>	SS304 or Carbon steel	3.2	2.15

Non standard material and color: See uni Material and Color Overview.

## Accessories

### Rubber Top

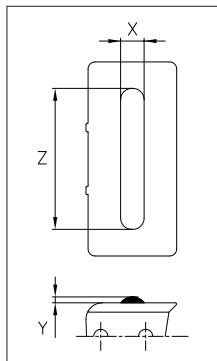

When ordering, please state the required distance between the Rubber Top.

Other Non Standard rubber profiles: See uni Rubber Profile Overview.

Width	Link material	Rubber material	Z		X		Y	
			mm	in	mm	in	mm	in
<b>K325</b>	POM-LFI <b>BR</b>	05 <b>I</b>	60.0	2.36	10.0	0.39	2.5	0.10
<b>K450</b>	POM-LFI <b>BR</b>	05 <b>I</b>	105.0	4.13	10.0	0.39	2.5	0.10
<b>K500</b>	POM-LFI <b>BR</b>	05 <b>I</b>	105.0	4.13	10.0	0.39	2.5	0.10
<b>K1000</b>	POM-LFI <b>BR</b>	05 <b>I</b>	170.0	6.69	10.0	0.39	2.5	0.10

STRAIGHT RUNNING

PITCH 19.1 MM/0.75 IN



## Sprocket

No of teeth	Pitch diameter		Hub diameter		Overall width L		Tooth width B		Bore		Machined S1045
	mm	in	mm	in	mm	in	mm	in	mm	in	
Z19	115.7	4.56	80.0	3.15	35.0	1.38	11.7	0.46	16.0	0.63	✓
Z20	121.8	4.79	80.0	3.15	35.0	1.38	11.7	0.46	16.0	0.63	✓
Z25	152.0	5.98	90.0	3.54	40.0	1.57	11.7	0.46	20.0	0.79	✓

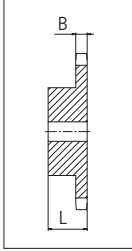

**Please ensure that sufficient size shaft and keyway are chosen for corresponding load.**

Non standard material and color:  
See uni Material and Color Overview.

Other sprocket sizes are available upon request.  
uni Retainer Rings: See uni Retainer Ring data sheet.