

# Special Plastic Chain

Series **uni NH78** Type -

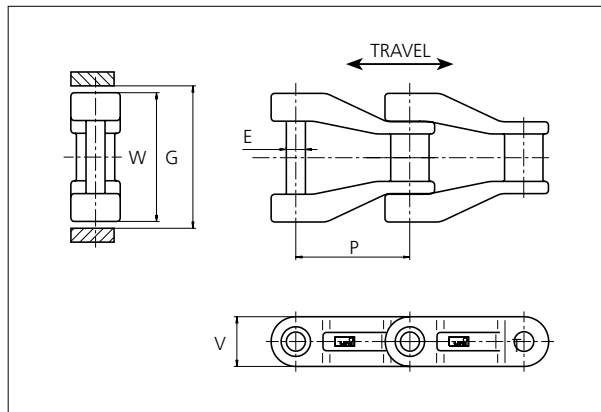

### Special Plastic Chain

Straight running chain  
 Pitch: 66.3 mm (2.61 in)  
 Backflex radius: 75.0 mm (3.00 in)  
 Permissible tensile strength:  
 T1: 9000 N (2023 lbf)  
 T2: 7000 N (1574 lbf)  
 T3: 6000 N (1349 lbf)  
 T4: 6000 N (1349 lbf)  
 T5: 5000 N (1124 lbf)

Standard shipping lengths:  
 boxes of 92 links  
 = 6.100 m (20.0 ft)

STANDARD

E		G		P		V	
mm	in	mm	in	mm	in	mm	in
11.0	0.43	78.0	3.07	66.3	2.61	28.6	1.13

All dimensions are for chains in POM material.

### Standard material & colors

	Width (W)		Material & color	Pin material	Pin fixing	Pin ø		Weight	
	mm	in				mm	in	kg/m	lb/ft
uni NH78 T1	74.0	2.91	POM-LF <span style="border: 1px solid black; padding: 2px;">BR</span> POM-D <span style="border: 1px solid black; padding: 2px;">G</span>	SS304	Staked	11.0	0.43	2.1	1.41

### Non Standard material & colors

	Width (W)		Material & color	Pin material	Pin fixing	Pin ø		Weight	
	mm	in				mm	in	kg/m	lb/ft
uni NH78 T2	74.0	2.91	PBT-GR <span style="border: 1px solid black; padding: 2px;">K</span> PA6-GF <span style="border: 1px solid black; padding: 2px;">K</span>	SS304	Staked	11.0	0.43	2.1	1.41
uni NH78 T3	74.0	2.91	PA6-GF <span style="border: 1px solid black; padding: 2px;">K</span>	SS304	Staked (PE sleeve)	10.0	0.39	2.1	1.41
uni NH78 T4	74.0	2.91	PA6-GF <span style="border: 1px solid black; padding: 2px;">K</span>	SS304	Cotterpin (PE sleeve)	10.0	0.39	2.1	1.41
uni NH78 T5	74.0	2.91	PP-AR <span style="border: 1px solid black; padding: 2px;">N</span>	SS304	Staked	11.0	0.43	2.1	1.41

STRAIGHT RUNNING

PITCH 66.3 MM/2.61 IN

## Sprocket

No. of teeth	Pitch diameter		Overall-diameter		Min. ø bore		Max. ø bore		Hub-diameter		A-dimension		B-dimension		 Machined PA6
	mm	in	mm	in	mm	in	mm	in	mm	in	mm	in	mm	in	
<b>Z6</b>	132.6	5.22	137.4	5.40	20.0	0.80	40.0	1.60	65.0	2.60	43.1	1.70	80.6	3.20	✓
<b>Z8</b>	173.3	6.82	182.6	7.20	20.0	0.80	40.0	1.60	65.0	2.60	65.8	2.60	100.9	4.00	✓
<b>Z10</b>	214.5	8.44	226.6	8.90	20.0	0.80	50.0	2.00	73.5	2.90	87.7	3.50	121.6	4.80	✓

Non standard material and color:  
See uni Material and Color Overview.

### Machined sprocket

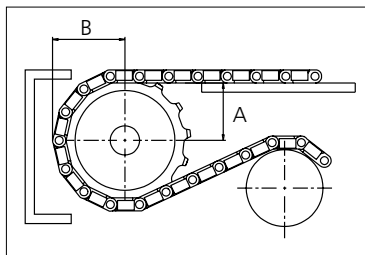

Please ensure that sufficient size shaft and keyway are chosen for corresponding load.

Other sprocket sizes are available upon request  
 Width of tooth: 15.8 mm/0.62 in  
 Width of sprocket: 42.3 mm/1.67 in  
 uni Retainer Rings: See uni Retainer Ring data sheet