

Paso de 25.4 mm (1.00 pulgadas)



uni S-MPB – una banda fuerte e higiénica de paso 1 pulgada

uni S-MPB es una banda fuerte e higiénica que se usa en diferentes aplicaciones alimentarias. La barra de refuerzo en la cara inferior garantiza una resistencia elevada a impactos. La banda uni S-MPB se suministra en la banda uni Single Link® única con soportes uni Single Link® (no módulos intercalados) para una limpieza óptima. La versión antiadherente garantiza la separación del producto de la banda.

La banda uni S-MPB es la preferida en las siguientes industrias/ aplicaciones:

- Cárnicas (ternera y cerdo), incluyendo líneas de corte de grasa, líneas de corte, transporte general, transporte de bandejas y líneas de empaquetado
- Fruta y verdura, incluyendo elevadores, mesas de inspección y líneas de empaquetado
- Marisco, incluyendo mesas de inspección, líneas de clasificación y de corte
- Panadería, incluyendo manipulado de masa cruda, líneas de enfriamiento y de empaquetado

Características del producto y ventajas de funcionamiento:

- La banda con uni Single Link® es fácil de limpiar y reduce hasta un 70% los tiempos muertos dedicados a limpieza
- La banda uni Single Link® (no modular) reduce el crecimiento de bacterias
- En la banda uni Single Link® los cuchillos no quedan atrapados en las juntas direccionales de la banda
- El sistema de cierre único (lockpin) permite un mantenimiento más sencillo y rápido
- El engranaje único de las ruedas permite más carga de producto y transportadores más largos
- Los soportes uni Single Link®, gruesos y fuertes, eliminan huecos en el ancho, evitando que el producto quede atrapado
- Aplicaciones con transferencias ajustadas

Plastic Modular Belt

Series **uni S-MPB** Type **C**

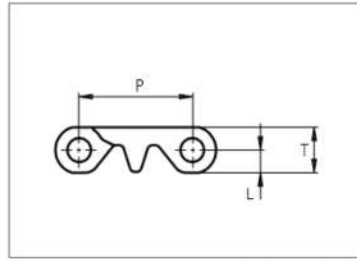

Straight running belt
 Nominal pitch: 25.4 mm (1.00 in)
 Surface type: Flat
 Surface opening: Closed
 Backflex radius: 23.0 mm (0.91 in)
 Pin diameter: 5.0 mm (0.20 in)

STANDARD

Belt material & color	POM-DI W	PP W	POM-DI B	PP B	PE-I B N	
	Pin material & color	PP W	PP B	PE N		
	P (Nominal)	25.4	1.00	T	10.3	0.41
	L	5.2	0.20	-	-	-

Non standard material and color: See uni Material and Color Overview.

Alternative pin and lock materials: Lockpin: PBT LG PA6.6 N D

STRAIGHT RUNNING

Belt width		Permissible tensile force (Belt/pin material)						Belt weight (Belt/pin material)						*Min. No. drive sprocket per shaft	Number of wear strips (Min. No.)	
		POM-DI/PP		PP/PP		PE-I/PP		POM-DI/PP		PP/PP		PE-I/PP			**Carry (pcs)	**Return (pcs)
mm	in	N	lbf	N	lbf	N	lbf	kg/m	lb/ft	kg/m	lb/ft	kg/m	lb/ft			
77	3.0	1810	407	732	164	604	136	0.6	0.43	0.4	0.29	0.4	0.29	2	2	2
153	6.0	3596	808	1454	327	1201	270	1.3	0.85	0.9	0.58	0.9	0.59	2	2	2
184	7.2	4317	971	1745	392	1442	324	1.5	1.02	1.0	0.69	1.0	0.70	2	2	2
229	9.0	5382	1210	2176	489	1798	404	1.9	1.28	1.3	0.86	1.3	0.88	2	2	2
305	12.0	7168	1611	2898	651	2394	538	2.5	1.70	1.7	1.15	1.7	1.17	3	3	2
381	15.0	8954	2013	3620	814	2991	672	3.2	2.13	2.1	1.43	2.2	1.46	3	3	2
457	18.0	10740	2414	4342	976	3588	806	3.8	2.55	2.6	1.72	2.6	1.75	4	4	2
507	20.0	11910	2677	4815	1082	3978	894	4.2	2.83	2.8	1.91	2.9	1.94	4	4	2
533	21.0	12527	2816	5064	1138	4184	941	4.4	2.97	3.0	2.01	3.0	2.04	4	4	2
609	24.0	14313	3218	5786	1301	4781	1075	5.1	3.40	3.4	2.29	3.5	2.33	5	5	3
685	27.0	16100	3619	6508	1463	5378	1209	5.7	3.82	3.8	2.58	3.9	2.62	5	5	3
761	30.0	17886	4021	7231	1625	5975	1343	6.3	4.25	4.3	2.86	4.3	2.92	6	6	3
837	33.0	19673	4422	7953	1788	6571	1477	6.9	4.67	4.7	3.15	4.8	3.21	6	6	3

PITCH 25.4 MM/1.00 IN

Additional standard belt widths are available in steps of 76.0 mm (2.99 in). Additional non-standard belt widths are available in steps of 12.7 mm (0.50 in).

1977	77.8	46460	10444	18782	4222	15519	3489	16.4	11.03	11.1	7.44	11.3	7.57	14	14	7
------	------	-------	-------	-------	------	-------	------	------	-------	------	------	------	------	----	----	---

Additional standard belt widths are available in steps of 76.0 mm (2.99 in). Additional non-standard belt widths are available in steps of 12.7 mm (0.50 in).

2965	116.7	69678	15664	28168	6332	23275	5232	24.6	16.54	16.6	11.16	16.9	11.36	20	20	10
------	-------	-------	-------	-------	------	-------	------	------	-------	------	-------	------	-------	----	----	----

General belt tolerance is +0/-0.4% at 23°C/3° and 50% RH. For exact belt width contact Customer Service. Non standard belt width on request.

*Max. Load per Drive Sprocket. Belt material: POM-DI 1100 N (247 lbf), PP 500 N (112 lbf), PE 500 N (112 lbf).

**Max. Spacing between wear strips, Carry: 152.0 mm (6.00 in); Return: 304.0 mm (12.00 in).

 = Single Link



Plastic Modular Belt

Series **uni S-MPB** Type **N**

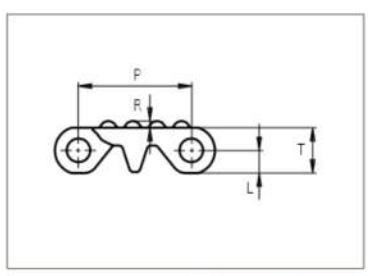

Straight running belt
 Nominal pitch: 25.4 mm (1.00 in)
 Surface type: No Cling
 Surface opening: Closed
 Backflex radius: 23.0 mm (0.91 in)
 Pin diameter: 5.0 mm (0.20 in)

STANDARD

Belt material & color	POM-DI W	PE-I B		mm	in		mm	in	
Pin material & color	PP W	PE N		P (Nominal)	25.4	1.00	L	5.20	0.20
				R	1.50	0.06	T	10.3	0.41

Non standard material and color: See uni Material and Color Overview.
 Alternative pin and lock materials: Lockpin: PBT **LG** PA6.6 **D** **N** PP **B**
 *Single Link K2000 is available with a molded indent of 38.6mm(1.52in) in both sides.

STRAIGHT RUNNING

Belt width		Permissible tensile force (Belt/pin material)				Belt weight (Belt/pin material)				*Min. No. drive sprocket per shaft	Number of wear strips (Min. No.)	
		POM-DI/PP		PE-I/PE		POM-DI/PP		PE-I/PE			**Carry (pcs)	**Return (pcs)
mm	in	N	lbf	N	lbf	kg/m	lb/ft	kg/m	lb/ft			
77	3.0	1810	407	604	136	0.6	0.43	0.4	0.29	2	2	2
153	6.0	3596	808	1201	270	1.3	0.85	0.9	0.59	2	2	2
229	9.0	5383	1210	1798	404	1.9	1.28	1.3	0.88	2	2	2
305	12.0	7169	1612	2395	538	2.5	1.70	1.7	1.17	3	3	2
381	15.0	8956	2013	2992	672	3.2	2.13	2.2	1.46	3	3	2
457	18.0	10742	2415	3588	807	3.8	2.55	2.6	1.75	4	4	2
507*	20.0	11910	2677	3978	894	4.2	2.83	2.9	1.94	4	4	2
533	21.0	12529	2816	4185	941	4.4	2.97	3.0	2.04	4	4	2
609	24.0	14315	3218	4782	1075	5.1	3.40	3.5	2.33	5	5	3
685	27.0	16102	3620	5379	1209	5.7	3.82	3.9	2.62	5	5	3
761	30.0	17888	4021	5975	1343	6.3	4.25	4.3	2.92	6	6	3
837	33.0	19675	4423	6572	1477	6.9	4.67	4.8	3.21	6	6	3
913	36.0	21461	4824	7169	1612	7.6	5.09	5.2	3.50	7	7	4

PITCH 25.4 MM/1.00 IN

Additional standard belt widths are available in steps of 76.0 mm (2.99 in). Additional non-standard belt widths are available in steps of 12.7 mm (0.50 in).
 1977 77.8 46460 10444 15519 3489 16.4 11.03 11.3 7.57 14 14 7

Additional standard belt widths are available in steps of 76.0 mm (2.99 in). Additional non-standard belt widths are available in steps of 12.7 mm (0.50 in).
 2965 116.7 69678 15664 23275 5232 24.6 16.54 16.9 11.36 20 20 10

General belt tolerance is +0/-0.4% at 23°C/73°F and 50% RH. For exact belt width contact Customer Service. Non standard belt width on request.
 *Max. Load per Drive Sprocket. Belt material: POM-DI 1100 N (247 lbf), PE 500 N (112 lbf).
 **Max. Spacing between wear strips, Carry, 152.0 mm (6.00 in), Return, 304.0 mm (12.00 in).
 □ = Single Link



Accessories

Rubber Top

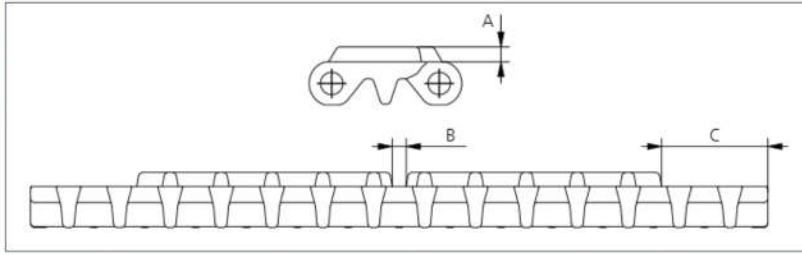
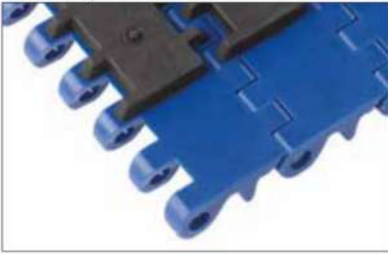

Type	Belt material & color	Rubber material & color	A		B		C		Link size	Width	
			mm	in	mm	in	mm	in		mm	in
Flat	PP B	03 K	3.5	0.14	3.5	0.14	26.5	1.04	K725	184.2	7.25

Non Standard material and color: See uni Material and Color Overview.

Accessories

Flight

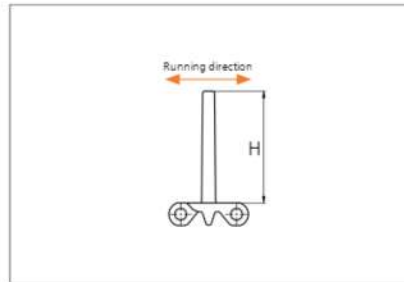

Type	Material & color	H		Link size	Width		Indent both sides	
		mm	in		mm	in	mm	in
13% Non Stick	POM-DI W B	76.2	3.00	K600	151.9	5.98	00.0	0.00
Flat	PP-I W B PE-I N B	50.8	2.00	K2000	506.7	19.95	25.8	1.02

Accessories

Side Guard

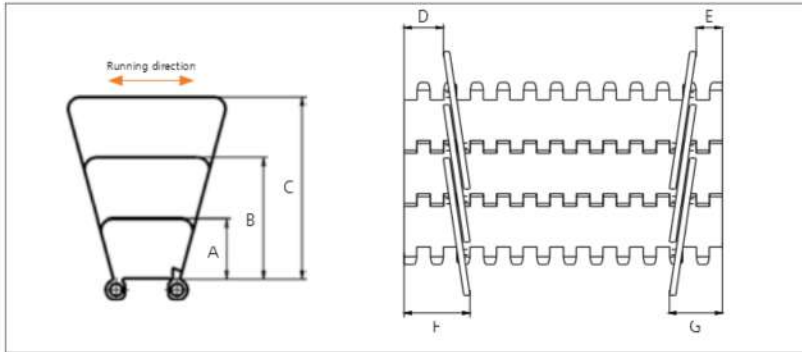

Type	Material & color	A		B		C		D		E		F		G	
		mm	in	mm	in	mm	in	mm	in	mm	in	mm	in	mm	in
Closed	PP-I W B	25.4	1.00	50.8	2.00	76.2	3.00	18.7	0.74	12.5	0.49	31.5	1.24	25.3	1.00

Minimum indent to outside of side guide: 14.0 mm (0.55 in). Increment 6.4 mm (0.25).

Non Standard material and color: See uni Material and Color Overview.

Backflex radius for Side Guide: 75.0 mm (2.95 in).

Accessories

Tab

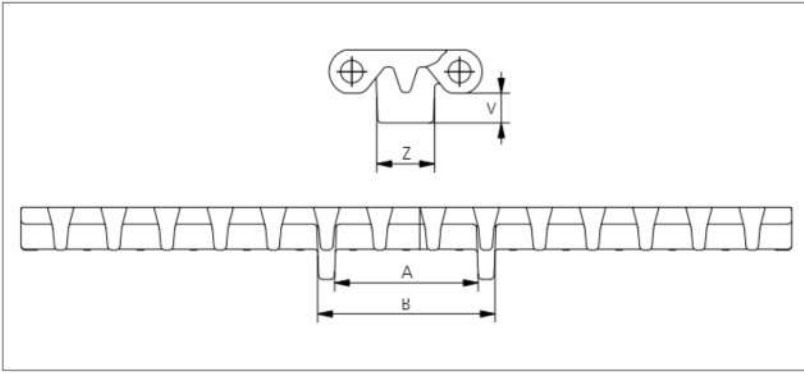
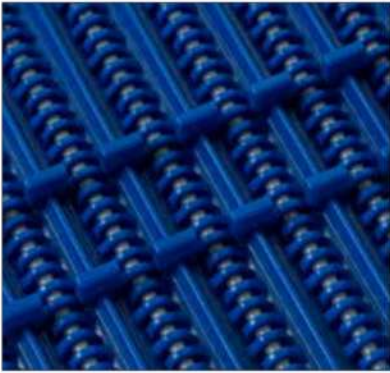

Type	Belt material & color	V		Z		A		B		Link size	Width	
		mm	in	mm	in	mm	in	mm	in		mm	in
Bottom Guide	POM-DI W PP W B	7.0	0.28	13.9	0.55	33.4	1.31	42.8	1.69	K725	184.2	7.25

Non Standard material and color: See uni Material and Color Overview.

Accessories

AmFlight

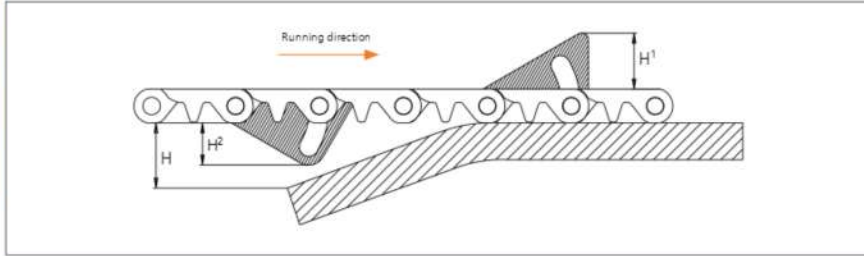

Type	Material & color	H		H ¹		H ²	
		mm	in	mm	in	mm	in
Push	PE W	17.0	0.67	17.0	0.67	13.3	0.52

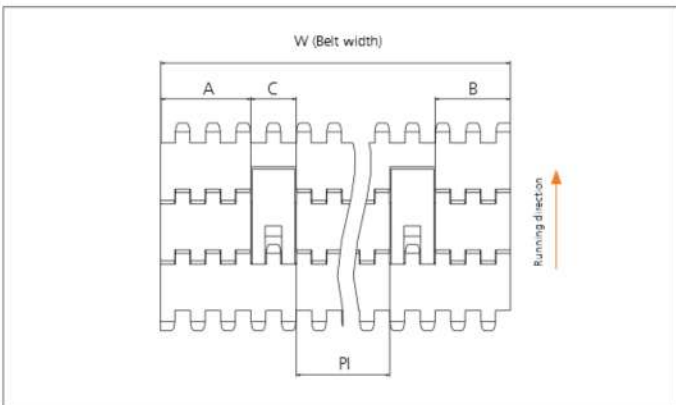

	mm	in
A min	38.4	1.51
B min	32.1	1.26
C	18.0	0.71
PI max	W - 106.5	W - 4.19
PI min	32.8	1.29

Increment: 12.7 mm (0.50 in).

Plastic Modular Belt

Series **uni S-MPB** Type **22% CS**

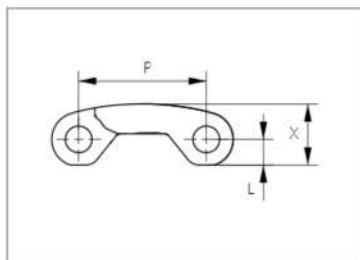

Straight running belt
 Nominal pitch: 25.4 mm (1.00 in)
 Surface type: Curved Surface
 Surface opening: 22%
 Backflex radius: 23.0 mm (0.91 in)
 Pin diameter: 5.0 mm (0.20 in)

Belt material & color	POM-DI W	PP W	PP B	PE-I B		mm	in		mm	in			
					P (Nominal)	25.4	1.00	X	12.1	0.48			
Pin material & color	PP W		PP B		PE N			L	5.2	0.20	-	-	-

Non standard material and color: See uni Material and Color Overview.

Alternative pin and lock materials: Lockpin: PBT **LG** PA6.6 **N**, **D**

Belt width		Permissible tensile force (Belt/pin material)						Belt weight (Belt/pin material)						*Min. No. drive sprocket per shaft	Number of wear strips (Min. No.)	
		POM-DI/PP		PP/PP		PE-I/PE		POM-DI/PP		PP/PP		PE-I/PE			**Carry (pcs)	**Return (pcs)
mm	in	N	lbf	N	lbf	N	lbf	kg/m	lb/ft	kg/m	lb/ft	kg/m	lb/ft			
77	3.0	1810	407	732	164	604	136	0.5	0.36	0.4	0.24	0.4	0.24	2	2	2
153	6.0	3596	808	1454	327	1201	270	1.1	0.72	0.7	0.48	0.7	0.48	2	2	2
229	9.0	5383	1210	2176	489	1798	404	1.6	1.08	1.1	0.72	1.1	0.72	2	2	2
305	12.0	7169	1612	2898	652	2395	538	2.1	1.44	1.4	0.96	1.4	0.96	3	3	2
381	15.0	8956	2013	3620	814	2992	672	2.7	1.79	1.8	1.20	1.8	1.20	3	3	2
457	18.0	10742	2415	4343	976	3588	807	3.2	2.15	2.1	1.44	2.1	1.44	4	4	2
533	21.0	12529	2816	5065	1139	4185	941	3.7	2.51	2.5	1.68	2.5	1.68	4	4	2
609	24.0	14315	3218	5787	1301	4782	1075	4.3	2.87	2.9	1.92	2.9	1.92	5	5	3
685	27.0	16102	3620	6509	1463	5379	1209	4.8	3.22	3.2	2.16	3.2	2.16	5	5	3
761	30.0	17888	4021	7231	1626	5975	1343	5.3	3.58	3.6	2.40	3.6	2.40	6	6	3
837	33.0	19675	4423	7954	1788	6572	1477	5.9	3.94	3.9	2.64	3.9	2.64	6	6	3
913	36.0	21461	4824	8676	1950	7169	1612	6.4	4.30	4.3	2.88	4.3	2.88	7	7	4
989	38.9	23248	5226	9398	2113	7766	1746	6.9	4.65	4.6	3.12	4.6	3.12	7	7	4

Additional standard belt widths are available in steps of 76.0 mm (2.99 in). Additional non-standard belt widths are available in steps of 12.7 mm (0.50 in).

1977	77.8	46460	10444	18782	4222	15519	3489	13.8	9.30	9.3	6.24	9.3	6.24	14	14	7
------	------	-------	-------	-------	------	-------	------	------	------	-----	------	-----	------	----	----	---

Additional standard belt widths are available in steps of 76.0 mm (2.99 in). Additional non-standard belt widths are available in steps of 12.7 mm (0.50 in).

2965	116.7	69678	15664	28168	6332	23275	5232	20.8	13.95	13.9	9.37	13.9	9.37	20	20	10
------	-------	-------	-------	-------	------	-------	------	------	-------	------	------	------	------	----	----	----

General belt tolerance is +0/-0.4% at 23°C/73°F and 50% RH. For exact belt width contact Customer Service. Non standard belt width on request.

*Max. Load per Drive Sprocket. Belt material: POM-DI 1100 N (247 lbf), PP 500 N (112 lbf), PE 500 N (112 lbf).

**Max. Spacing between wear strips, Carry: 152 mm (6 in); Return: 304 mm (12 in).

□ = Single Link



STANDARD

STRAIGHT RUNNING

PITCH 25.4 MM/1.00 IN

Accessories
Flight

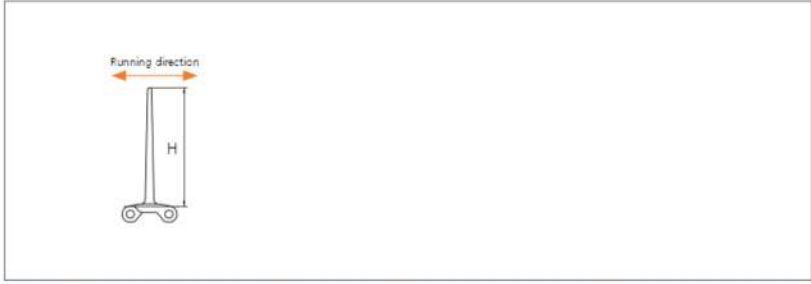

Type	Material & color	H		Link size	Width		Indent both sides	
		mm	in		mm	in	mm	in
CS Flat	POM-D <input type="checkbox"/> W PP-I <input type="checkbox"/> W <input type="checkbox"/> B PE-I <input type="checkbox"/> N <input type="checkbox"/> B	76.2	3.00	K600	151.9	5.98	00.0	0.00

Sprocket

No. of teeth	Bore size										Overall diameter		Pitch-diameter		Hub-diameter		Dimension A		Dimension B		Double row/Two way	Molded	Machined
	Pilot bore		19.05	20.00	25.40	30.00	31.75	38.10	40.00	60.00													
	mm	in																					
Z06	✓	●	●								48.9	1.92	50.8	2.00	33.0	1.30	16.9	0.67	30,75	1.21	✓	✓	
Z08	✓			●	●	●					65.6	2.58	66.4	2.61	50.0	1.97	25.6	1.01	38,53	1.51	✓		✓
Z10	✓			●	●	●		●			82.2	3.23	82.2	3.24	66.0	2.60	34.0	1.34	46,44	1.82	✓	✓	
Z12	✓			●	●	●		●	●		98.6	3.88	98.1	3.86	70.0	2.76	42.3	1.67	54,42	2.14	✓	✓	
Z15	✓			●	●	●	■	■	■	■	123.1	4.84	122.2	4.81	100.0	3.94	54,54	2.15	66,43	2.62	✓	✓	
Z20	✓					●	●	●	■	■	163.8	6.44	162.4	6.39	100.0	3.94	75,08	2.96	86,53	3.41	✓	✓	

■ Molded sprocket

● Machined sprocket



Other sprocket sizes are available upon request.
 Other bore sizes on sprockets are available upon request.
 Round bores are always delivered with keyway.
 Max. load per sprocket shown does not take bore size into account.
 Please also ensure that sufficient size shaft is chosen for corresponding load.

Width of tooth = Single row: 6.35 mm (0.25 in)
 = Double row: 12.7 mm (0.50 in)

Width of One-part sprocket = Double row: 25.0 mm (0.98 in)

uni UltraClean Two-Part Sprocket

No. of teeth	Bore size		Overall diameter		Pitch-diameter		Hub-diameter		Dimension A		Dimension B		Single row/Two way	Molded
	in	1.57												
	mm	40.0												
Z12	■		98.6	3.88	98.1	3.86	80.0	3.15	42.3	1.67	54.42	2.14	✓	✓
Z15	■		123.1	4.84	122.2	4.81	80.0	3.15	54,54	2.15	66,43	2.62	✓	✓
Z20	■		163.8	6.44	162.4	6.39	118.0	4.65	75,08	2.96	86,53	3.41	✓	✓

■ Moulded uni UltraClean TwoPart Sprocket

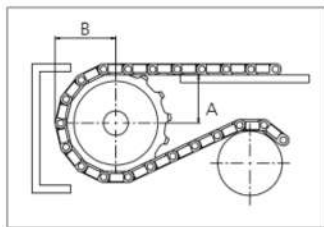

Width of UltraClean Two part sprocket = Single row: 44.0 mm (1.73 in)
 Width of UltraClean Two-part tooth = Single row: 6.35 mm (0.25 in)

uni Retainer Rings: See uni Retainer Ring data sheet.
 For correct sprocket position: See uni Assembly Instructions for uni S-MPB.
 For more detailed sprocket information, contact Customer Service.